



# K-1A1 KEY SYSTEM SALES BROCHURES

## No. 5931 and No. 5936

### 1959

Two sales brochures presenting Kellogg ITT's 6 button sets and Key Service Units for four lines and a common talk intercom. The 5931 also shows other 1A1 compatible sets and the colors available at the time.

Number 5936 is printed two color, 11 X 17 inches, folded in half to produce a 8.5 X 11 brochure. Printed on 20 pound stock using the lithography method. Number 5931 is printed four color process, 11 X 21 inches, folded twice to produce a 8.5 X 11 brochure with a 4 inch half page. Printed on 20 pound coated stock using the lithography method. The half pages appear together as the last page of the PDF.

Scanned and produced by Mike Neale.

[www.kelloggtelephone.com](http://www.kelloggtelephone.com)

Member of  
Antique Telephone Collectors Association USA  
Telephone Collectors International USA  
Telecom Heritage Group UK

Adobe document copyright 2006, Mike Neale, Midland, Texas, USA





***KELLOGG***

# **K-1A1 KEY TELEPHONE SYSTEM**

*Situation*

**TWO PHYSICIANS  
AND ONE DENTIST  
ESTABLISH A MEDICAL CENTER**





# 1A1 KEY TELEPHONE SYSTEM INSTALLATION

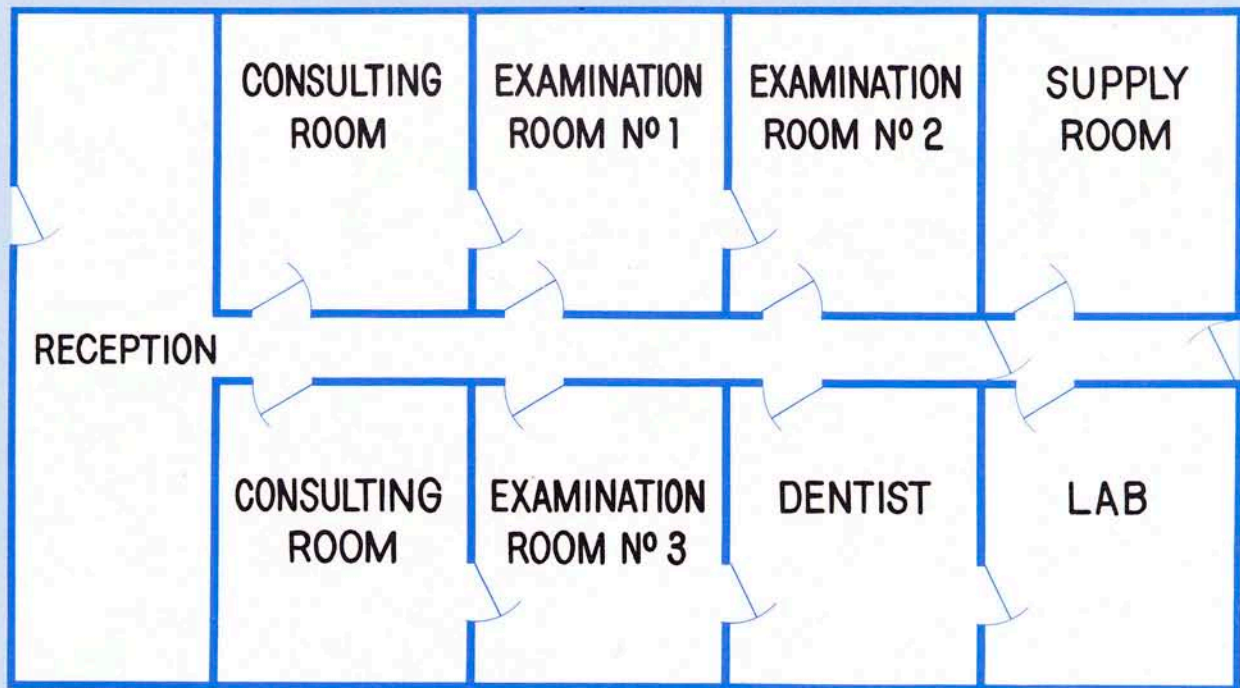

**Situation** - TWO PHYSICIANS AND ONE DENTIST  
ESTABLISH A MEDICAL CENTER



- DESIRE TELEPHONE SERVICE IN ALL ROOMS WITH DIAL INTER-COMMUNICATION BETWEEN ALL LOCATIONS
- REQUIRE THREE CENTRAL OFFICE LINES AND ILLUMINATION IN ALL TELEPHONES
- WANT COLOR TELEPHONES IN FOUR LOCATIONS



# MONTHLY RATES

ITEM		RATE
3	- C.O. LINES @ 12.00	\$ 36.00
6	- EXTENSIONS @ 1.65	9.90
3	- LINE HOLDS @ .50	1.50
3	- LINE ILLUMINATIONS @ 1.25	3.75
1	- COMMON EQUIPMENT @ 1.00	1.00
9	- TELEPHONE ILLUMINATIONS @ .75	6.75
36	- LINE PICK-UPS @ .35	12.60
9	- HOLDS @ .35	3.15
1	- INTERCOM @ 1.25	1.25
9	- INTERCOM BELLS @ .50	4.50

	TOTAL	\$ 80.40
LESS 3 - C.O. LINES		36.00
K-1A1 EQUIPMENT ONLY		44.40
K-1A1 EQUIPMENT ONLY - YEARLY		<b>\$532.80</b>

## SERVICE CONNECTION CHARGES

3 - C.O. LINES	@ 6.00	\$ 18.00
6 - EXTENSIONS	@ 3.00	18.00

## INSTALLATION CHARGES

9 - K-1A1 TELEPHONES	@ 3.50	31.50
9 - SPRING CORDS	@ .75	6.75

## COLOR CHARGE

4 - K-1A1 TELEPHONES	@ 7.50	30.00
----------------------	--------	-------

**TOTAL \$104.25**





# KELLOGG K-1A1 KEY TELEPHONE SYSTEM



## KELLOGG SWITCHBOARD AND SUPPLY COMPANY

A DIVISION OF INTERNATIONAL TELEPHONE AND TELEGRAPH CORPORATION

### REGIONAL OFFICES

**CALIFORNIA**  
23 Broderick Road  
Burlingame, California  
OXford 7-5780

**GEORGIA**  
1594 Southland Circle, N.W.  
Atlanta 18, Georgia  
SYcamore 4-2441

**ILLINOIS**  
4600 So. Tripp Ave.  
Chicago 32, Illinois  
CLiffside 4-4300

**KANSAS**  
7th Street and Sunshine Road  
Kansas City 15, Kansas  
MAYfair 1-4418

**NEW YORK**  
327 North West Street  
Syracuse, New York  
HARRison 2-9251

**OHIO**  
1555 West Fourth Street  
Mansfield, Ohio  
LAFayette 4-6511

**TEXAS**  
1515 Turtle Creek Boulevard  
Dallas 7, Texas  
RIVERSide 7-5191

**EXPORT**  
157 Prospect Street  
Passaic, New Jersey  
PRescott 3-5100

QUANTITY	CODE	DESCRIPTION	PRICE	TOTAL
1	KIA1 (301) 961	KEY TELEPHONE SYSTEM, BACKBOARD HINGED FRAME, COVER & CIRCUITS FOR ILLUMINATION, C.O. LINES, LINE HOLDING	\$190.65	\$190.65
5	56400 (BA)02D	KEY TELEPHONES, 6-BUTTON, BLACK, 130 BA RINGER AND KOIL KORD	66.90	334.50
4	56409 (BA)02D	KEY TELEPHONES, 6-BUTTON, IVORY, 130 BA RINGER AND KOIL KORD	69.40	277.60
36	K51 (A) 745	STATION LAMPS, 10 VOLT	51.00c	18.36
9	30 ( ) 785	CONNECTING BLOCKS	4.66	41.94
1	K207 (A) 962	DIAL INTERCOM-FEATURE (1 TO 9 STATIONS)	62.20	62.20
K-1A1 EQUIP. TOTAL				\$925.25

## SUPPLY ITEMS

300 FEET	(Approx. Requirement)	WIRING CABLE, 21 PR. #22 AWG, PLASTIC COVERED CABLE	\$49.80
1	(RT2B) 999	LORAIN POWER SUPPLY UNIT	170.60
SUPPLY ITEMS TOTAL			\$220.40
GRAND TOTAL			\$1,145.65



**FOR BETTER COMMUNICATIONS**



**K-1A1**

**KEY TELEPHONE SYSTEMS**

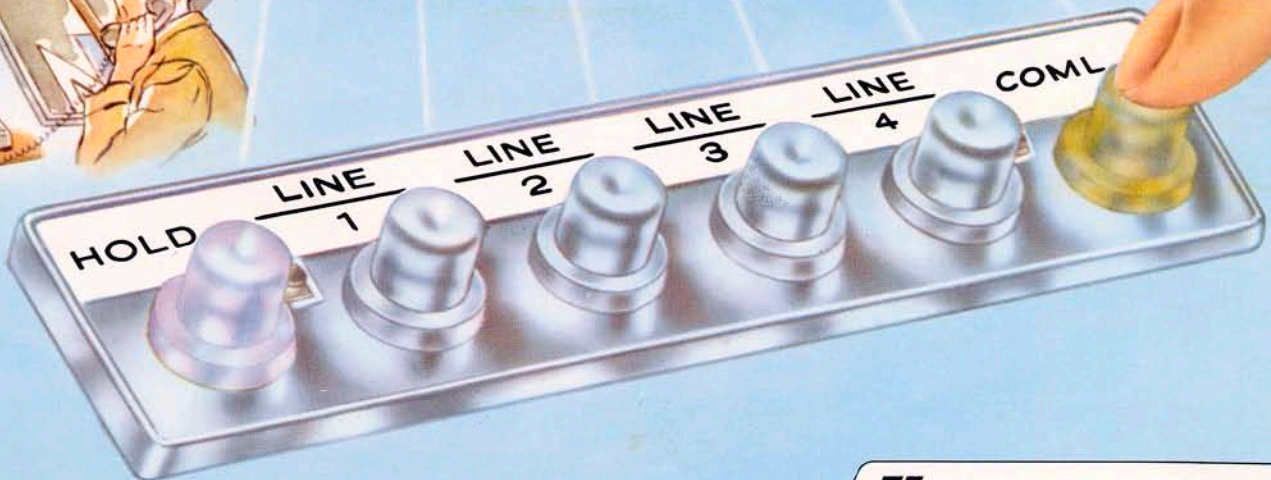

**KELLOGG** Communications Division of  
**ITT**



# Push Button Convenience at Your Fingertips

The K-1A1 Key Telephone System enables one or more push-button telephones to share up to five lines for answering, originating, holding, intercommunicating or transferring calls without the assistance of an attendant or operator.

—Answer and originate calls on from one to five Central Office, private branch exchange, inter-

communicating, private lines, or combinations thereof.

- Hold calls at all telephones.
- Answer and originate calls on manual or dial intercommunicating lines between telephones in a K-1A1 Key Telephone System.
- Privacy on calls—the executive exclusion feature can be provided when privacy is desired.



**INDUSTRIAL**



**PROFESSIONAL**



**MILITARY**



*Whatever your business needs, Kellogg can provide a Push-Button telephone system which will give you greater flexibility, more convenience, increased efficiency, and improved service to your customers.*





### **OUTSIDE CALLS**

You can place or receive calls on any one of these four buttons. The secretary can answer any line in the office from the telephone on her desk, or she can transfer calls to other telephones, all without the need of walking from one desk to another.



### **INTERCOMMUNICATIONS CALL**

One button connects you to the intercom line, allowing two or more people to confer from their own desks with a consequent saving in time and energy.

### **HOLDING**

You can hold a call on one line while answering or placing a call on another. When you complete the second call, you can return to the first. This saves both time and money for you, as well as your customer because it eliminates a "call back".



**• • A BETTER WAY TO COMMUNICATE**



# MORE CONVENIENCE FROM KELLOGG



## K-575

This telephone embodies the advantages of the selection of two lines *plus* a "hold" device. Simply by lifting the left-hand plunger, either line may be "held" which permits the use of the other line.



## K-510

Here is a telephone which provides the selection of either of two lines. By depressing the line selection turn button, manual signalling is permitted. This is an option with the K-510.



## K-544

The four button K-544 may be connected to three incoming lines, or like the six button, wiring may be varied to meet specific applications . . . for example, two subscriber lines and one tie-line.



PINK

LIGHT GRAY

GREEN

IVORY

BLUE

BEIGE

BLACK

WHITE

RED

YELLOW



## KELLOGG SWITCHBOARD AND SUPPLY COMPANY

A Division of International Telephone and Telegraph Corporation

6650 S. CICERO CHICAGO 38, ILLINOIS

### REGIONAL OFFICES

**CALIFORNIA**  
23 Broderick Road  
Burlingame, California  
OXford 7-5780

**GEORGIA**  
1594 Southland Circle, N.W.  
Atlanta 18, Georgia  
SYcamore 4-2441

**ILLINOIS**  
4600 So. Tripp Ave.  
Chicago 32, Illinois  
CLiffside 4-4300

**KANSAS**  
7th St. and Sunshine Rd.  
Kansas City 15, Kansas  
MAYfair 1-4418

**NEW YORK**  
327 North West Street  
Syracuse, New York  
HARRison 2-9251

**OHIO**  
1555 West Fourth Street  
Mansfield, Ohio  
LAFayette 4-6511

**TEXAS**  
1515 Turtle Creek Blvd.  
Dallas 7, Texas  
RIVERSide 7-5191

**EXPORT**  
157 Prospect Street  
Passaic, New Jersey  
PRescott 3-5100



# K-1A1 FEATURES

**HOLD**  
Just press hold button to "hold" one call, then press line pick-up button to answer or place another call. A visual flashing signal may be provided for each line pick-up button as a reminder that a line is being "held."

**LINE PICK-UP BUTTONS**  
Central Office or private branch exchange line pick-up buttons illuminated for visual indication flash signals for incoming calls — steady light on lines in use — Lights show on all telephones simultaneously.

**INTERCOM**  
Dial or manual intercom line. No need of purchasing a separate phone system for inter-office calls.

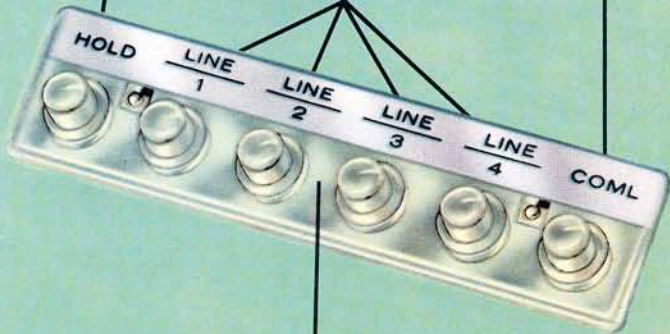

## EXECUTIVE EXCLUSION FEATURE

The K-1A1 may be equipped to cut other telephones off the line by lifting the plunger, permitting confidential calls. The line is automatically restored when the handset is replaced.

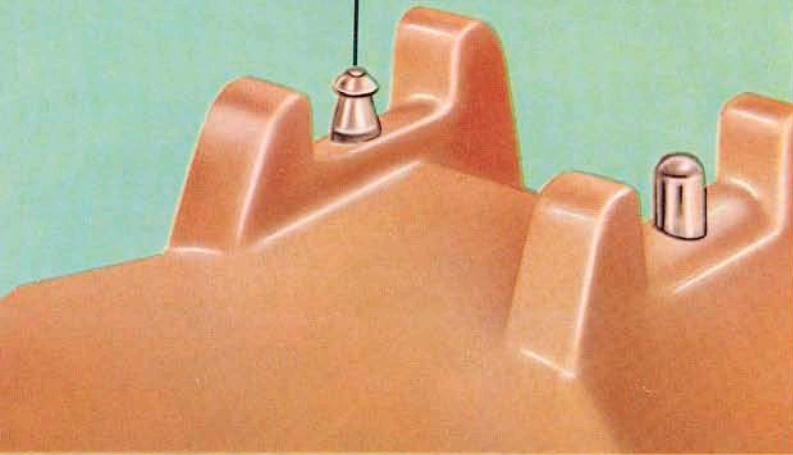

## APPARATUS CABINET

The operating equipment is housed in one compact cabinet which permits its installation at almost any desired wall location. This also allows expansion when needed without moving or rearranging the apparatus.

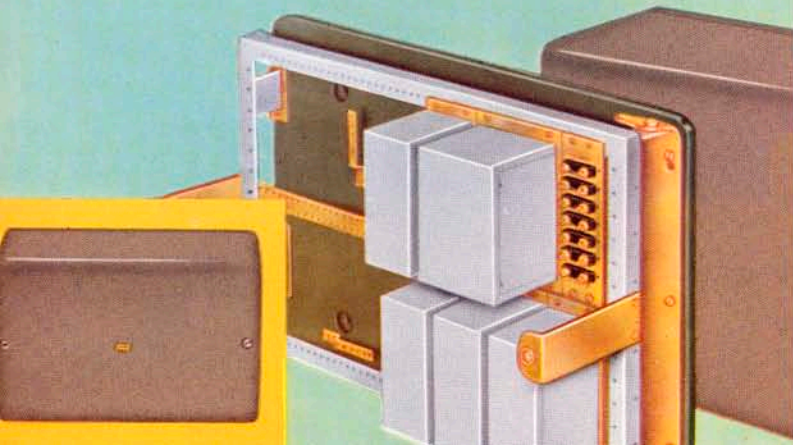

HERE IS HOW

**K-1A1**

CAN SOLVE

*Your*

**COMMUNICATIONS  
PROBLEM**



## *The Problem*

1. Distinguishing which phone to answer.
2. Valuable desk space cluttered with telephones.
3. Lost time in transferring calls.
4. Outsiders overhearing private conversations.
5. Shouting or running from one desk to another.
6. Losing time and money in "call-backs."
7. Interruptions in phone conversations.



## *The Solution*

1. Visual signals to indicate incoming calls.
2. One phone with complete versatility.
3. No need to call an office switchboard to transfer a call.
4. Exclusion button prevents other users from obtaining the line.
5. Intercom button permits conversations with other desks without leaving your own.
6. The "hold" feature allows the holding of one line while another is used.
7. Illuminated buttons insure rapid identification of incoming calls and busy lines—avoids interruption of calls in progress.

**A FAST, EFFICIENT K-1A1 TELEPHONE  
SYSTEM WILL CUT YOUR COSTS,  
BOOST YOUR BUSINESS**